

# WCI

W. CHAN INVESTMENTS LTD.

FOR LEASE > RETAIL & OFFICE SPACE

## RETAIL CENTRE

15521 118 AVENUE EDMONTON AB



### PROPERTY DETAILS

The Retail Centre is located on the corner of 156<sup>th</sup> Street and 118 Avenue. Situated in one of the most populated industrial areas in Edmonton. The Retail Centre has direct exposure to 118 Avenue and 156 Street. Whether your business is retail, hospitality or office space this property will provide you with an excellent location. Some market highlights include:

- Lease rates starting at \$18.00 Per Sq. ft. Net
- Operating Costs \$6.00 Per Sq.ft (Est. 2015)
- On-Site Parking
- Term 5 Years minimum
- Tenant Improvement Packages Negotiable

Ryan de Boer  
Real Estate Manager  
Toll Free: 1-888-343-3388  
Phone: (403) 228-3838  
rdeboer@smittys.ca

# WCI

W. CHAN INVESTMENTS LTD.

WCI

W. CHAN INVESTMENTS LTD.

FOR LEASE > RETAIL & OFFICE SPACE

# RETAIL CENTRE

15521 118 AVENUE EDMONTON AB

## Available Premises

- Suite CRU 1 – 2,832 SQ.FT. - Available April, 2015
- Suite CRU 2 – 1,200 SQ.FT. - Available Immediately
- Suite CRU 3 – 2,450 SQ.FT. – Available Immediately
- Suite CRU 5 – 1,252 SQ.FT. – Available Immediately
- Suite CRU 6 – 6,012 SQ.FT. Available Immediately
  - Potential Restaurant Existing Kitchen In Place
  - Potential for Demising



Ryan de Boer  
Real Estate Manager  
Toll Free: 1-888-343-3388  
Phone: (403) 228-3838  
rdeboer@smittys.ca

WCI

W. CHAN INVESTMENTS LTD.

WCI

W. CHAN INVESTMENTS LTD.

FOR LEASE > RETAIL & OFFICE SPACE

# RETAIL CENTRE

15521 118 AVENUE EDMONTON AB

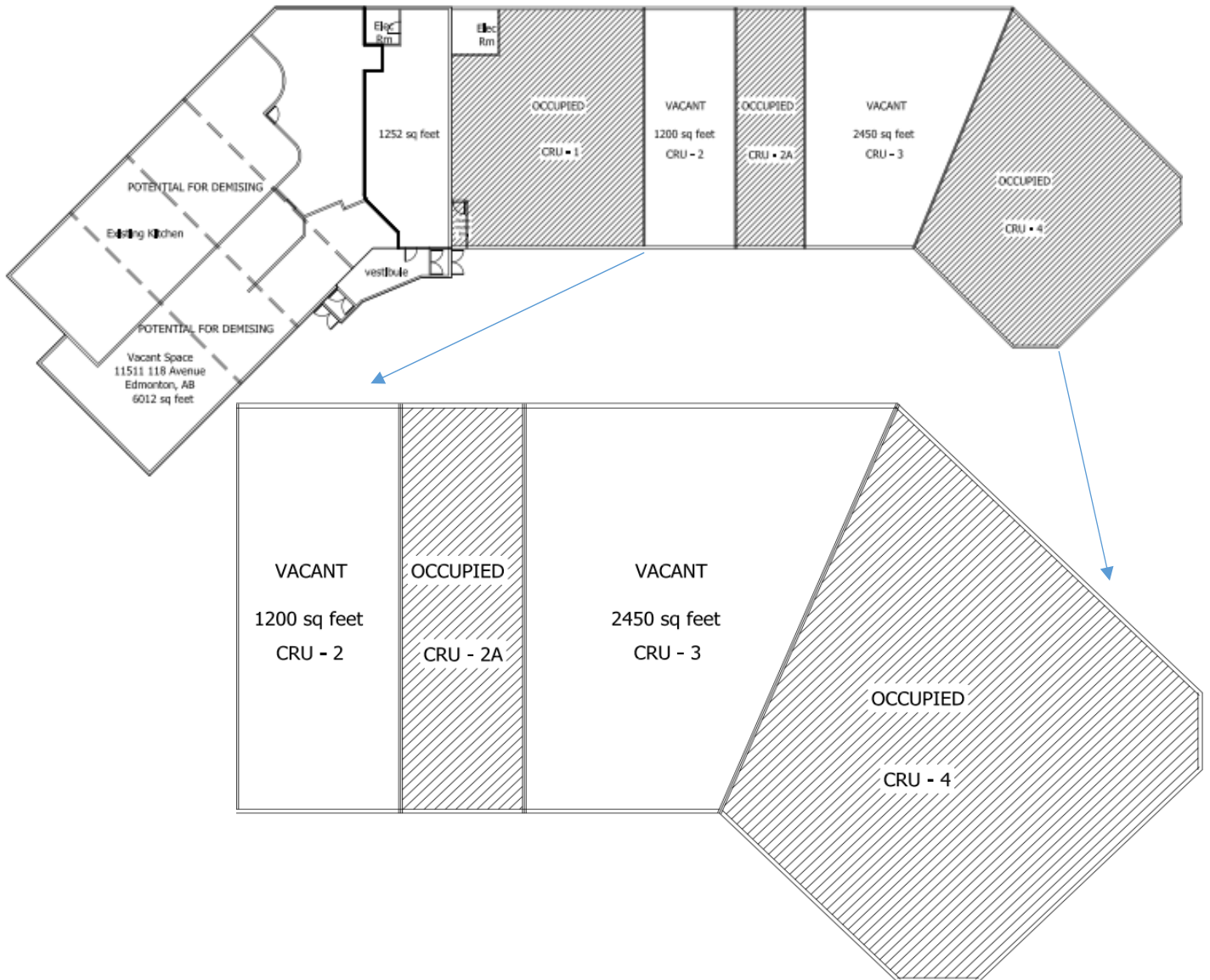

Ryan de Boer  
Real Estate Manager  
Toll Free: 1-888-343-3388  
Phone: (403) 228-3838  
rdeboer@smittys.ca

WCI

W. CHAN INVESTMENTS LTD.

FOR LEASE > RETAIL & OFFICE SPACE

# RETAIL CENTRE

15521 118 AVENUE EDMONTON AB

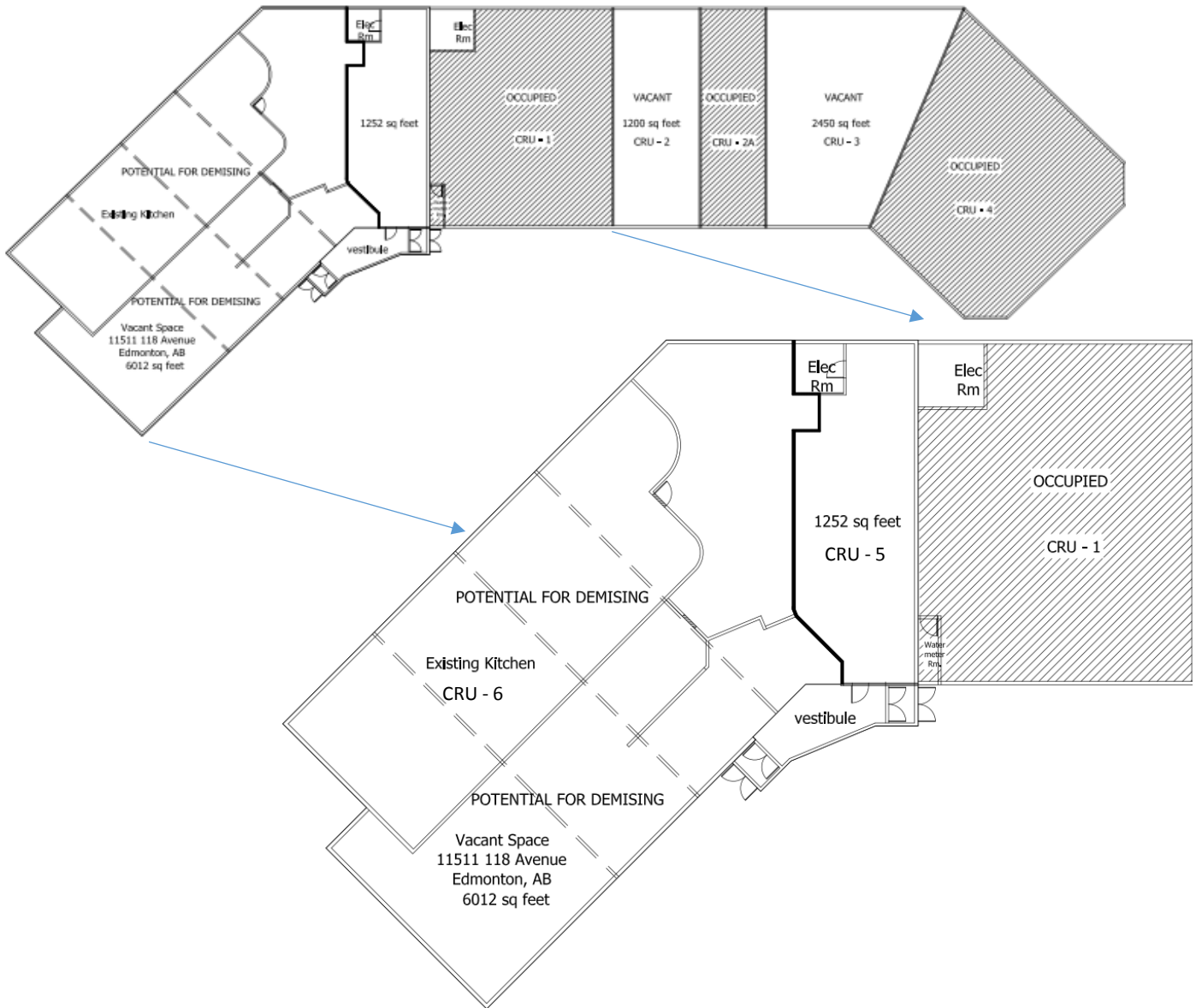

Ryan de Boer  
Real Estate Manager  
Toll Free: 1-888-343-3388  
Phone: (403) 228-3838  
rdeboer@smittys.ca